

USER IS RESPONSIBLE FOR VERIFICATION OF CURRENT REVISION BEFORE USING THIS DOCUMENT. DOCUMENT CONSIDERED "REFERENCE ONLY" IF NOT THE CURRENT REVISION.

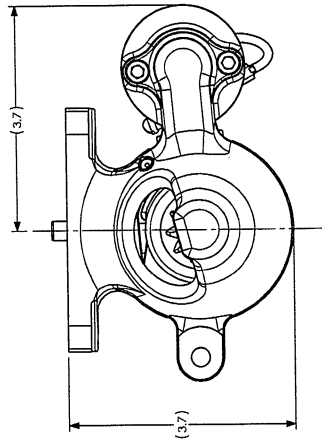

LS MODEL

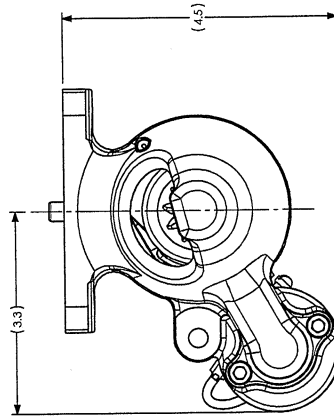
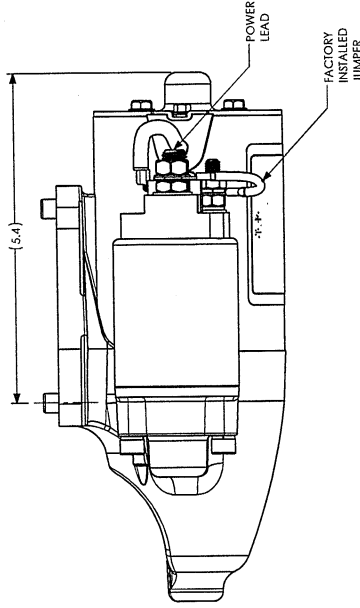

PM MODEL

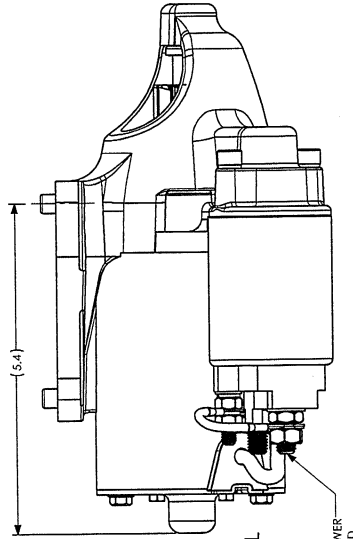

ECO	REV.	DESCRIPTION	BY	DATE
123518	K	1) REDRAWN IN SOLIDWORKS; 2) FORMAT - HET WAS SKETCH; 3) REMOVED PMA DATA TABLE AND LABEL GRAPHIC; 4) REMOVED INSTALLATION AIDS	EAB	10/20/16

INSTALLATION INSTRUCTIONS:

1. DISCONNECT POWER CABLE AND UNBOLT OLD STARTER FROM THE ENGINE.
2. MOUNT NEW STARTER USING THE NEW LOCK WASHERS SUPPLIED AND TORQUE TO 100 IN-LBS.
3. REMOVE THE CRANKING INFORMATION TAG FROM THE NEW STARTER BY REMOVING THE BMM NUT FROM THE POWER TERMINAL AND PLACE THE TAG IN CUSTOMER'S LOG.
4. ATTACH POWER CABLE USING A 13MM WRENCH ON THE BMM NUT PREVIOUSLY REMOVED FROM THE POWER TERMINAL AND TORQUE TO 50 IN-LBS. (DO NOT OVERTORQUE. INSULATOR WILL BREAK)
5. PLACE A MS25171 INSULATING NIPPLE OF THE PROPER SIZE ON THE POWER TERMINAL.
6. CONTINUING AIRWORTHINESS: THE STARTER SHOULD BE RETURNED TO THE FACTORY FOR OVERHAUL AT 2700 HOURS OF ENGINE OPERATION, OR WHEN A MAJOR OVERHAUL IS PERFORMED, OR IF SERVICING IS REQUIRED. AN OCCASIONAL DROP OF OIL ON THE PIGNON SHAFT TO HELP PREVENT RUST FROM FORMING. NO OTHER MAINTENANCE IS REQUIRED OR RECOMMENDED.

UNLESS OTHERWISE SPECIFIED DIMENSIONS ARE IN INCHES AND APPLY TO ALL DIMENSIONS UNLESS NOTED OTHERWISE		GEOMETRIC SYMBOLS PER ANSI Y14.5		DRAWN ENGINEER		EAB		10/20/16	
A = 1/16 X = 1/32 XX = 1/64 XXX = 1/128 BREAK ALL EDGES AND MACHINE ALL SURFACE FINISH		<input type="checkbox"/> FLAT <input type="checkbox"/> RADIUS <input type="checkbox"/> CHAMFER <input type="checkbox"/> HOLE <input type="checkbox"/> CONCENTRIC <input type="checkbox"/> HOLE POSITION <input type="checkbox"/> HOLE DIRECTION <input type="checkbox"/> HOLE DEPTH <input type="checkbox"/> HOLE LOCATION <input type="checkbox"/> HOLE TOLERANCE <input type="checkbox"/> HOLE POSITION TOLERANCE <input type="checkbox"/> HOLE DIRECTION TOLERANCE <input type="checkbox"/> HOLE DEPTH TOLERANCE <input type="checkbox"/> HOLE LOCATION TOLERANCE <input type="checkbox"/> HOLE POSITION TOLERANCE <input type="checkbox"/> HOLE DIRECTION TOLERANCE <input type="checkbox"/> HOLE DEPTH TOLERANCE <input type="checkbox"/> HOLE LOCATION TOLERANCE		APPROV. 123518		K. NORD			
ANGLES 5°		FINISH N/A		WEIGHT N/A		MATERIAL N/A			
SPECIFICATION CLASSIFICATION		NOTIF. NO.		SIZE C		SH 1		CODE ID 65PY1	
CLASSIFICATION		CONVENTION		OF 1		DRAWING NO. ST20101		REV. K	
CRITICAL <XX XX>		<P>		C		ST20101		K	
MAJOR [XX XX]		[P]		C		ST20101		K	
MINOR XX XX		#		C		ST20101		K	
REFERENCE [XX XX]		#		C		ST20101		K	
SCALE 2:3				C		ST20101		K	



2100 Science Highway  
Montgomery, AL 36118

LS/PM INSTALLATION INSTRUCTIONS

DRAWING NO. ST20101

REV. K